

### FEATURES

- > RF efficient design offers high power handling in a small package
- > Can be mounted in any position, any axis
- > Meets or exceeds standards set in MIL-R-83725

### PRODUCT SPECIFICATIONS

Contact & Relay Ratings	Units	G40P-001
<b>Contact Form</b>		P
<b>Contact Arrangement</b>		SPST-latching
<b>Voltage, Test Max., Contacts &amp; to Base (30 µA Leakage Max., dc or 60Hz)</b>	kV Peak	6
<b>Voltage, Operating Max., Contacts &amp; to Base (30 µA Leakage Max.)</b>		
dc or 60 Hz	kV Peak	5
2.5 MHz	kV Peak	4.5
16 MHz	kV Peak	3.5
32 MHz	kV Peak	2.8
<b>Current, Continuous Carry Max</b>		
dc or 60 Hz	Amps	65
2.5 MHz	Amps	45
16 MHz	Amps	25
32 MHz	Amps	14
<b>Coil Hi-Pot (V RMS, 60 Hz)</b>	V	500
<b>Capacitance</b>		
Across Open Contacts	pF	1.6
Contacts to Ground	pF	1.6
<b>Resistance, Contact Max @ 1A, 28 Vdc</b>	ohms	0.02
<b>Latch Time</b>	ms	1.5
<b>Reset Time</b>	ms	1.5
<b>Life, Mechanical</b>	cycles	2 million
<b>Weight, Nominal</b>	g (oz)	28 (1)
<b>Vibration, Operating, Sine (55-2000 Hz Peak)</b>	Gs	10
<b>Shock, Operating, 1/2 Sine 11ms (Peak)</b>	Gs	50
<b>Temperature Ambient Operating</b>	°C	-55 to +125

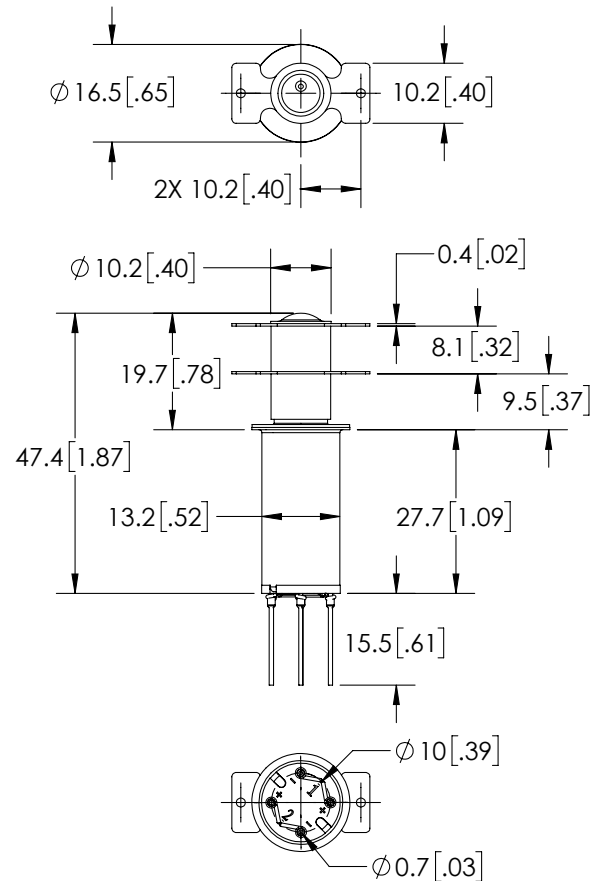

### PART NUMBER SYSTEM

G40P-001			
<b>Coil Voltage</b>	26.5 Vdc, Bus Wire		
<b>High Voltage Connections</b>		Solder connection	
<b>Mounting</b>			Std Flange

### COIL RATINGS

Nominal, Volts dc	26.5
Latch, Volts dc	1.5-13.75
Reset, Volts dc	1.5-13.75
Coil Resistance (Ohms $\pm 10\%$ )	80