

Make & Break Load Switching
 RoHS Compliant, date code 0701 and later

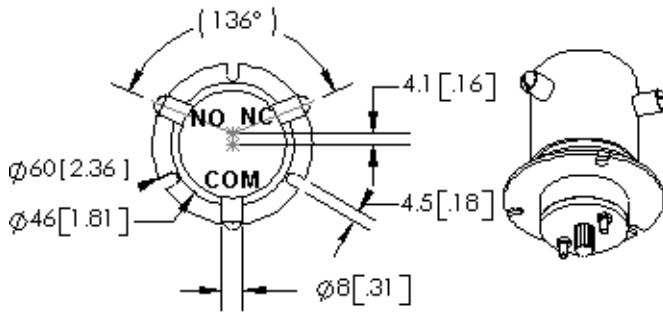
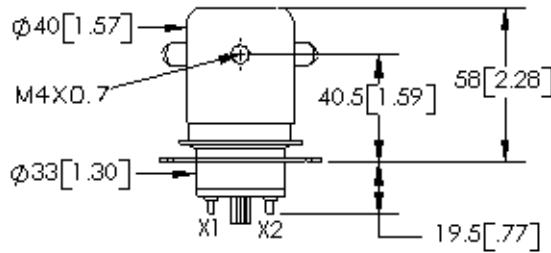

- FEATURES**
- High power, 75A carry, in a small package for demanding applications
 - Rugged Tungsten / Molybdenum contact set capable of switching under load *
 - Threaded high voltage connections for easy installation
 - User interchangeable coils provide driver versatility

*Consult factory for load switching applications.

PRODUCT SPECIFICATIONS		
Contact & Relay Ratings	Units	G9
Contact Form		C
Contact Arrangement		SPDT
Voltage, Test Max., Contacts & to Base (15 µA Leakage Max., dc or 60Hz)	kV Peak	20
Voltage, Operating Max., Contacts & to Base (15 µA Leakage Max.)		
dc or 60 Hz	kV Peak	15
2.5 MHz	kV Peak	13
16 MHz	kV Peak	10
32 MHz	kV Peak	8
Current, Continuous Carry Max		
dc or 60 Hz	Amps	75
2.5 MHz	Amps	35
16 MHz	Amps	22
32 MHz	Amps	17
Coil Hi-Pot (V RMS, 60 Hz)	V	500
Capacitance		
Across Open Contacts	pF	3
Contacts to Ground	pF	3.5
Resistance, Contact Max @ 1A, 28Vdc	ohms	0.010
Operate Time	ms	30
Release Time	ms	8
Life, Mechanical	cycles	1 million
Weight, Nominal	g (oz)	300 (11)
Vibration, Operating, Sine (55-500 Hz Peak)	G's	10
Shock, Operating, 1/2 Sine 11ms (Peak)	G's	50
Temperature Ambient Operating	°C	-55 to +125

COIL RATINGS	
Nominal, Volts dc	26.5
Pick-up, Volts dc, Max.	16
Drop-Out, Volts dc	1-10
Coil Resistance (Ohms ±10%)	190

For more information, refer to [Relay User Instructions](#)

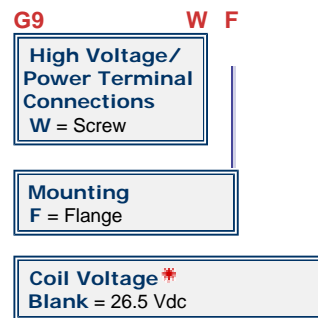

*Order the relay with the coil voltage in the part number as shown above. The coil voltage will appear on the coil plate near the coil terminals rather than in the P/N on the relay.