

Make Only Load Switching (Requires relay to be potted to be able to meet high voltage specifications)
RoHS Compliant, date code 0601 and later

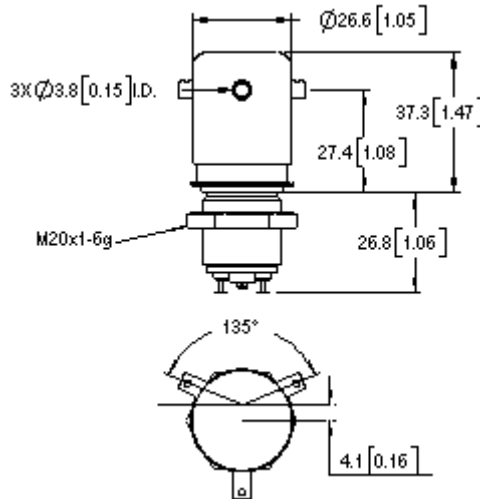

FEATURES	
◆	Unglazed ceramic relay offers true customer design flexibility
◆	Excellent for capacitive discharge and safety dump switch applications
◆	Effectively bounce free operation

PRODUCT SPECIFICATIONS		
Contact & Relay Ratings	Units	G60C
Contact Form		C
Contact Arrangement		SPDT
Voltage, Test Max., Contacts & to Base (15 µA Leakage Max., dc or 60Hz)	kV Peak	40*
Voltage, Operating Max., Contacts & to Base (15 µA Leakage Max.)		
dc or 60 Hz	kV Peak	35*
2.5 MHz	kV Peak	-
16 MHz	kV Peak	-
32 MHz	kV Peak	-
Current, Continuous Carry Max		
dc or 60 Hz	Amps	12
2.5 MHz	Amps	-
16 MHz	Amps	-
32 MHz	Amps	-
Coil Hi-Pot (V RMS, 60 Hz)	V	500
Capacitance		
Across Open Contacts	pF	-
Contacts to Ground	pF	-
Resistance, Contact Max @ 1A, 28 Vdc	ohms	1.0
Operate Time	ms	15
Release Time	ms	15
Life, Mechanical	cycles	1 million
Weight, Nominal	g (oz)	84 (3)
Vibration, Operating, Sine (55-500 Hz Peak)	G's	10
Shock, Operating, 1/2 Sine 11ms (Peak)	G's	50
Temperature Ambient Operating	°C	-55 to +125

COIL RATINGS			
Nominal, Volts dc	12	26.5	115
Pick-up, Volts dc, Max.	9	18	90
Drop-Out, Volts dc	.5 - 5	1 - 10	5 - 50
Coil Resistance (Ohms ±10%)	30	125	2000

Ratings listed are for 25°C, sea level conditions

For more information, refer to
[Relay User Instructions](#)

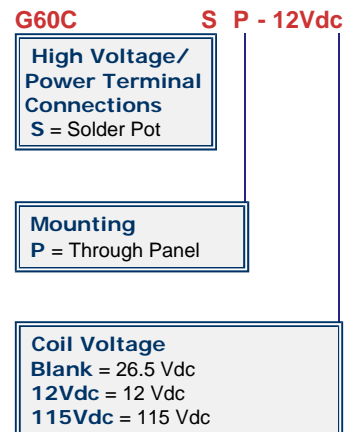

*Voltage ratings, Test Max and Operating Max, are based on customer supplied additional external isolation by encapsulation or immersion in a dielectric fluid.

04/03/08